

WALL LEGEND	WALL NOTES
	EXISTING 12" MASONRY WALL
	EXISTING 12" MASONRY WALL - 3 HR RATED (PARTY WALL)
	EXISTING 12" MASONRY WALL - 1 HR RATED (10'-0" FROM PROPERTY LINE)
	1 HR EXTERIOR WALL PER UL 425 (4'-0" FROM PROPERTY LINE)
	1 HR EXTERIOR WALL PER UL 425 (10'-0" FROM PROPERTY LINE)
	1 HR FIRE PARTITION PER UL 425 (SHAFT ENCLOSURE)
	1 HR FIRE PARTITION PER UL 425 (CORRIDOR WALL)
	NON RATED WALL ASSEMBLY
	FUTURE TENANT AND/OR SOUND SEPARATION WALL

- 1) ALL DIMENSIONS TO FACE OF STUDS OR FACE OF MASONRY WALLS UNLESS NOTED OTHERWISE (S.I.D.)
- 2) ALL NON-RATED WALLS TO BE 20 GAUGE METAL STUDS AT 24" O.C. U/L/C
- 3) ALL 2ND FLOOR EXTERIOR WALLS TO BE 5 1/2" THERMASTEEL PANELS - SEE UL DETAIL AND WALL SECTIONS FOR RATINGS AND SHEATHING REQUIREMENTS
- 4) ALL OTHER WALLS TO BE 3 1/2" METAL STUDS U/L/C
- 5) 1ST FLOOR EXTERIOR WALL FURRING STUDS TO BE 3 1/2" WOOD OR METAL AT 24" O.C.

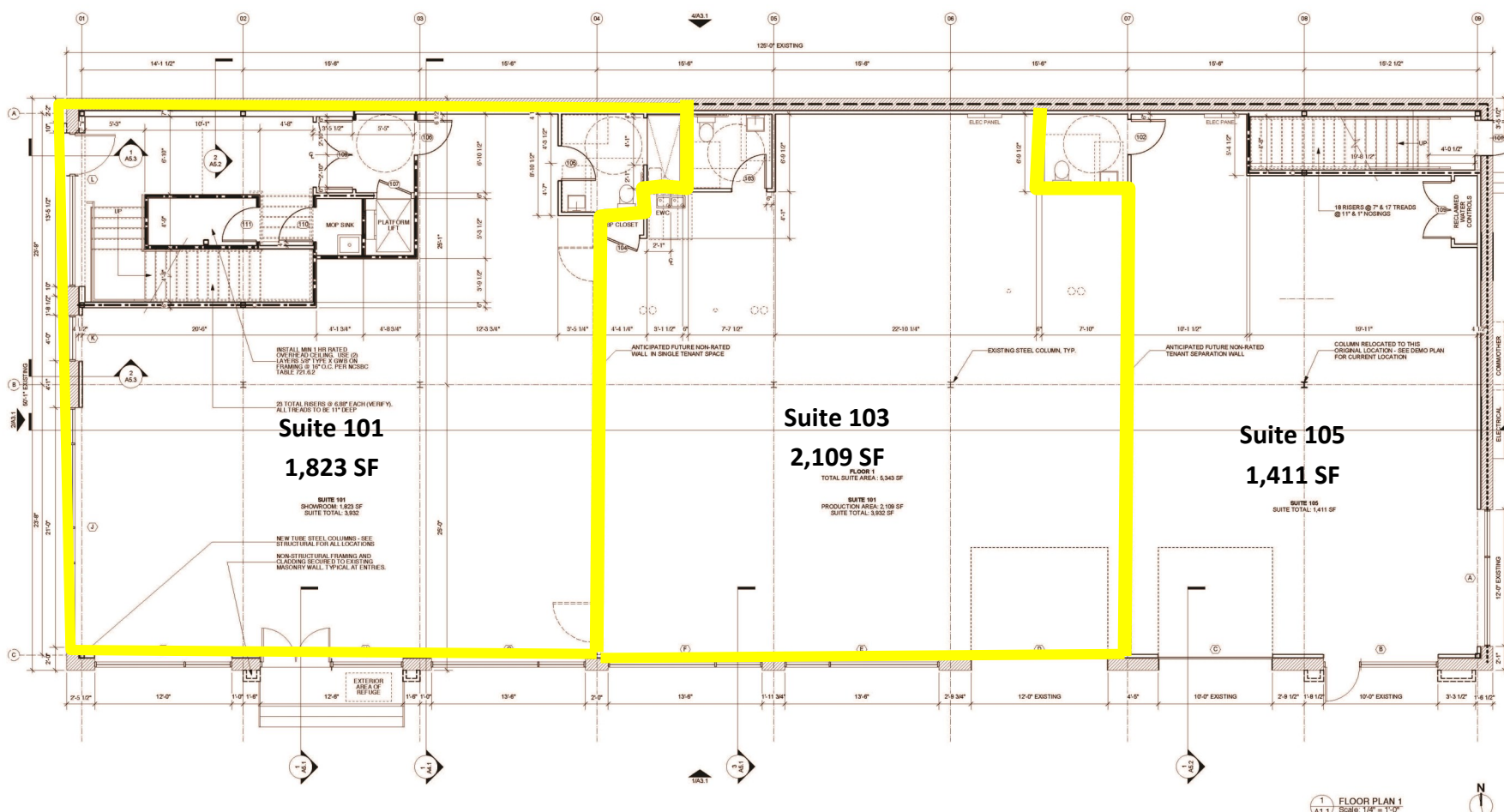

const doc permit set for electronic viewing only

const doc permit set for electronic viewing only

CLEARSENSE PROPERTIES
 project address: CLEARSENSE PROPERTIES, LLC, NC 27701
 owner's address: 121 ALLEGRETTON ST., DURHAM, NC 27701

DATE: 07/27/2011
 DRAWN: EJM
 CHECKED: EJM
 REVISION: EJM

CONSTRUCTION DOCUMENTS PERMIT SET

FLOOR PLANS
 A1.1

STUDIO B architecture
 phone: 919.687.2044
 1313/1315/1317/1319
 1319/1321/1323/1325
 1327/1329/1331/1333
 1335/1337/1339
 1341/1343/1345
 1347/1349/1351
 1353/1355/1357/1359
 1361/1363/1365/1367/1369
 1371/1373/1375/1377/1379
 1381/1383/1385/1387/1389
 1391/1393/1395/1397/1399
 1401/1403/1405/1407/1409
 1411/1413/1415/1417/1419
 1421/1423/1425/1427/1429
 1431/1433/1435/1437/1439
 1441/1443/1445/1447/1449
 1451/1453/1455/1457/1459
 1461/1463/1465/1467/1469
 1471/1473/1475/1477/1479
 1481/1483/1485/1487/1489
 1491/1493/1495/1497/1499
 1501/1503/1505/1507/1509
 1511/1513/1515/1517/1519
 1521/1523/1525/1527/1529
 1531/1533/1535/1537/1539
 1541/1543/1545/1547/1549
 1551/1553/1555/1557/1559
 1561/1563/1565/1567/1569
 1571/1573/1575/1577/1579
 1581/1583/1585/1587/1589
 1591/1593/1595/1597/1599
 1601/1603/1605/1607/1609
 1611/1613/1615/1617/1619
 1621/1623/1625/1627/1629
 1631/1633/1635/1637/1639
 1641/1643/1645/1647/1649
 1651/1653/1655/1657/1659
 1661/1663/1665/1667/1669
 1671/1673/1675/1677/1679
 1681/1683/1685/1687/1689
 1691/1693/1695/1697/1699
 1701/1703/1705/1707/1709
 1711/1713/1715/1717/1719
 1721/1723/1725/1727/1729
 1731/1733/1735/1737/1739
 1741/1743/1745/1747/1749
 1751/1753/1755/1757/1759
 1761/1763/1765/1767/1769
 1771/1773/1775/1777/1779
 1781/1783/1785/1787/1789
 1791/1793/1795/1797/1799
 1801/1803/1805/1807/1809
 1811/1813/1815/1817/1819
 1821/1823/1825/1827/1829
 1831/1833/1835/1837/1839
 1841/1843/1845/1847/1849
 1851/1853/1855/1857/1859
 1861/1863/1865/1867/1869
 1871/1873/1875/1877/1879
 1881/1883/1885/1887/1889
 1891/1893/1895/1897/1899
 1901/1903/1905/1907/1909
 1911/1913/1915/1917/1919
 1921/1923/1925/1927/1929
 1931/1933/1935/1937/1939
 1941/1943/1945/1947/1949
 1951/1953/1955/1957/1959
 1961/1963/1965/1967/1969
 1971/1973/1975/1977/1979
 1981/1983/1985/1987/1989
 1991/1993/1995/1997/1999
 2001/2003/2005/2007/2009